

# I-395/SR 836/I-95 DESIGN-BUILD PROJECT

Financial Project Numbers: 251688-1-52-01, 423126-1-52-01, 423126-2-52-01, 429300-2-52-01

03-25-2024

## NEW TRAFFIC PATTERN ON WESTBOUND I-395

On **WEDNESDAY MORNING, MARCH 27 (THURSDAY, MARCH 28 IS AN ALTERNATE DATE)**, a new traffic pattern will be implemented on the ramp to westbound I-395 and westbound I-395 from North Miami Avenue to I-95. Capacity will be increased on the ramp by removing an existing merge and providing two continuous lanes onto I-395 as shown below. Drivers heading to northbound I-95 should use the right lane on the ramp to access the northbound exit ramp located on the rightmost I-395 mainline lane.

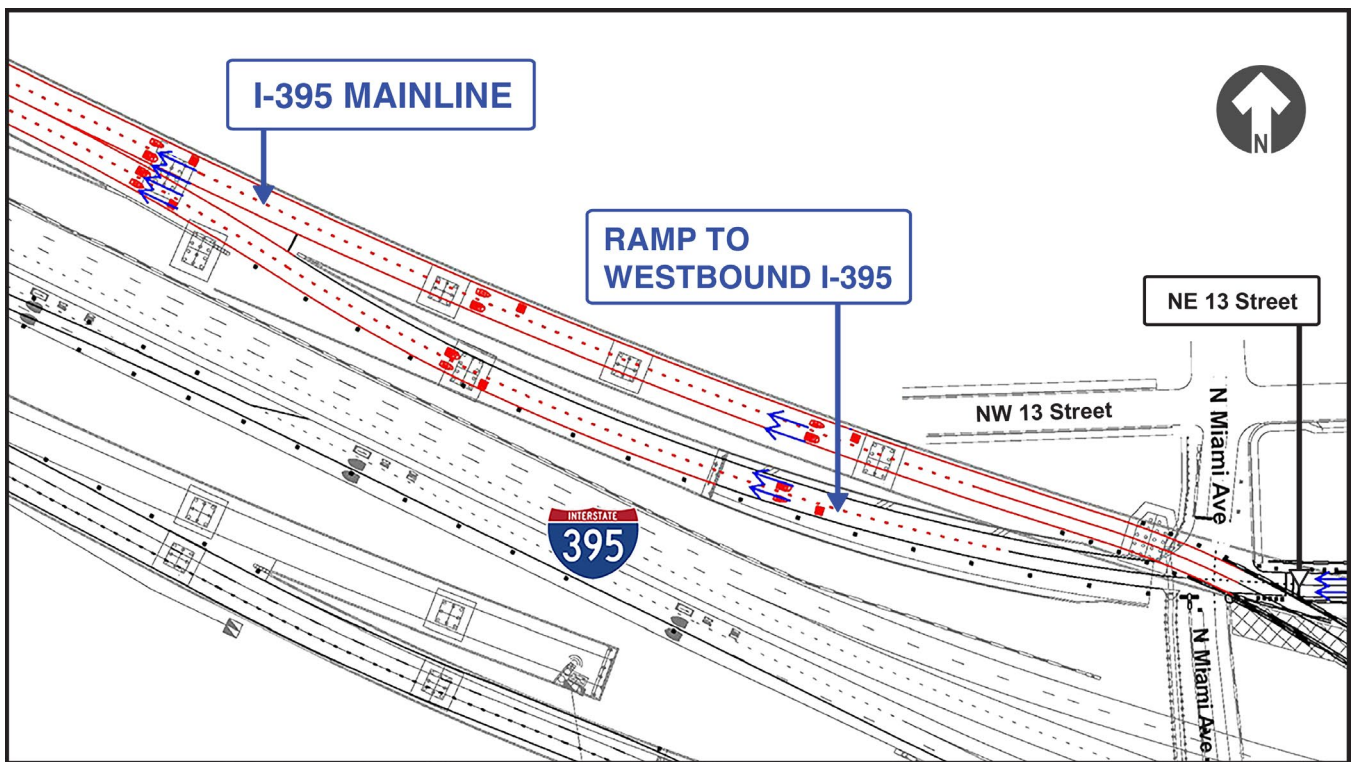

In addition, capacity will also be added on I-395 from North Miami Avenue to the northbound I-95 ramp by removing a merge and adding an additional travel lane. The right lane on I-395, currently a choice lane allowing drivers to either access northbound I-95 or continue west, will be converted to an exit only lane as shown below. Drivers heading to southbound I-95 or continuing west will stay in the left three lanes that will merge to two lanes.

*Continue reading on the next page...*

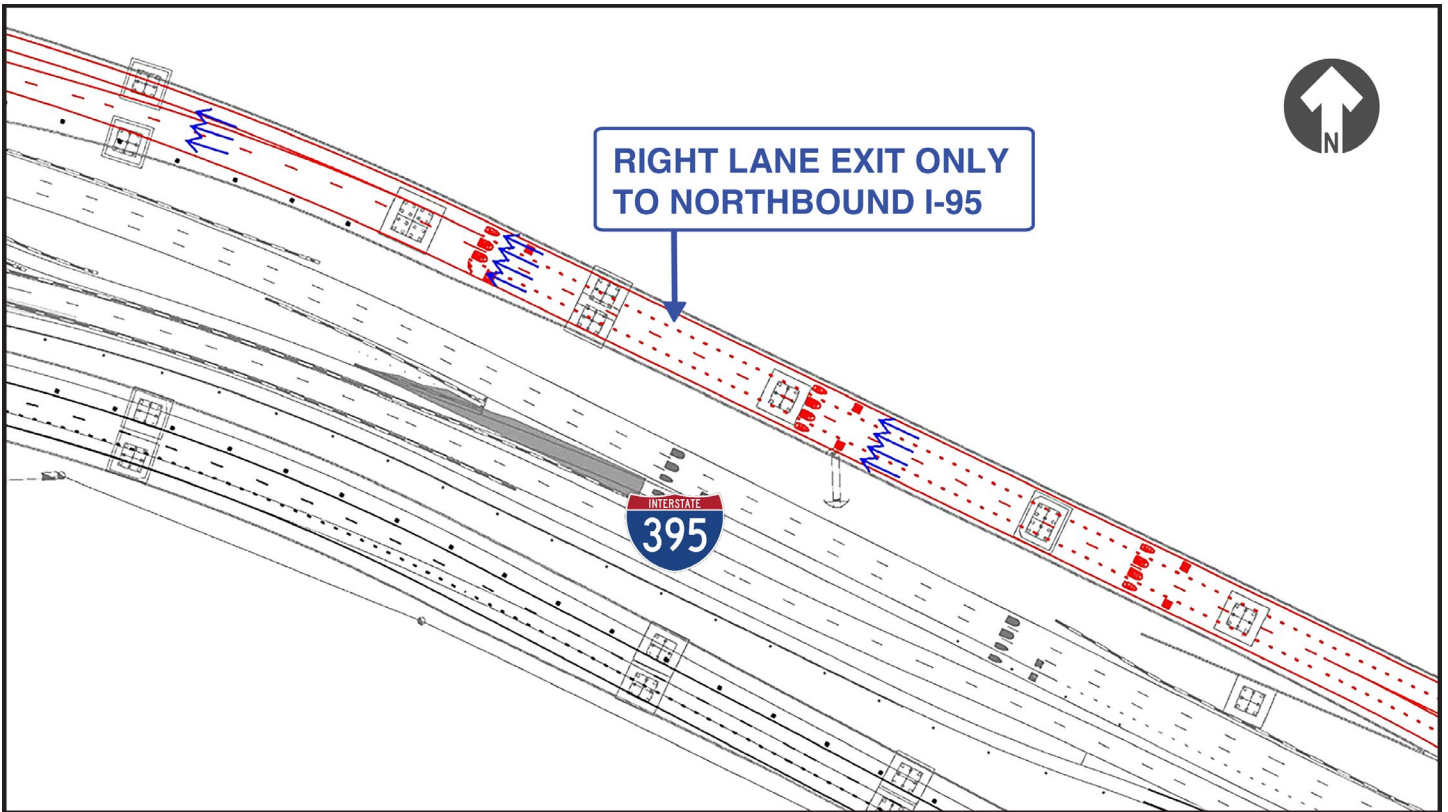

Pavement markings, signage and electronic message boards will be used to help guide drivers.

In order to complete the traffic shift, the following closures will be implemented:

## CLOSURE OF NORTH MIAMI AVENUE RAMP WESTBOUND I-395

- **TUESDAY, MARCH 26 (WEDNESDAY, MARCH 27 IS AN ALTERNATE DATE)** - The North Miami Avenue ramp to westbound I-395 will be closed between the hours of 11:30 p.m. and 6 a.m. To view a map of the detour, [CLICK HERE](#).

## FULL CLOSURE OF WESTBOUND I-395 AT THE BISCAIYNE BOULEVARD EXIT RAMP

- **TUESDAY, MARCH 26 (WEDNESDAY, MARCH 27 IS AN ALTERNATE DATE)** - All westbound travel lanes on I-395 will be closed at the Biscayne Boulevard exit ramp between the hours of 11:30 p.m. and 6 a.m. to implement a traffic shift. To view a map of the detour, [CLICK HERE](#).

*Continue reading on the next page...*

# FULL CLOSURE OF SOUTHBOUND I-95 AT SR 836

- **MONDAY, MARCH 25, WEDNESDAY, MARCH 27 AND THURSDAY, MARCH 28** - All southbound lanes on I-95 will be closed at SR 836 between the hours of 11:45 p.m. and 5:30 a.m. for overhead work.
  - Non-Tolled detour route for southbound I-95:
    - Exit at the SR 836 West Ramp, then exit at NW 14 Street
    - Turn left at NW 12 Avenue, then turn left at NW 11 Street
    - Turn right at NW 8 Street Road, then turn left at NW 8 Street
    - Turn right at NW 3 Court to access the I-95 south ramp after NW 2 Street
  - Tolled detour route for southbound I-95:
    - Exit at the SR 836 West Ramp, then exit at NW 12 Avenue
    - Turn left at NW 12 Avenue to access the SR 836 east entrance ramp
    - Continue east on SR 836 to access the I-95 south ramp

TO VIEW A MAP OF THE DETOUR PLEASE [CLICK HERE.](#)

---

## ABOUT THE PROJECT

The I-395/SR 836/I-95 Design-Build Project will add capacity, enhance the flow of traffic and safety and improve access along I-395, SR 836 and I-95.



To view a video of the project,  
please visit:

[i395-miami.com/project-video](http://i395-miami.com/project-video)

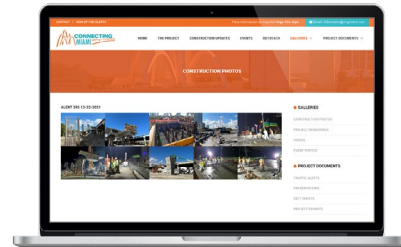

To view updated project photos,  
please visit:

[i395-miami.com/construction-photos](http://i395-miami.com/construction-photos)

*Continue reading on the next page...*

---

**Please note that this schedule may change due to bad weather or other unforeseen conditions.**

The work is part of the I-395/SR 836/I-95 Design-Build Project that will reconstruct the I-395 corridor from the SR 836/I-395/I-95 (Midtown) Interchange to the MacArthur Causeway Bridge, including the construction of a Signature Bridge over NE 2 Avenue and Biscayne Boulevard; double-deck SR 836 from west of NW 17 Avenue to the Midtown Interchange and the replacement of the concrete pavement on I-95 from NW 8 Street to NW 29 Street.

For additional information on the project please contact Oscar Gonzalez at 786-280-0983 or via email at [Oscar.Gonzalez2@dot.state.fl.us](mailto:Oscar.Gonzalez2@dot.state.fl.us). Additional project information can be found on the project website, [www.I-395miami.com](http://www.I-395miami.com).

---

For information on scheduled lane closures on FDOT Construction Projects that affect traffic to/from and in Miami Beach, please [click here](#).