

I-395/SR 836/I-95 DESIGN-BUILD PROJECT

Financial Project Numbers: 251688-1-52-01, 423126-1-52-01, 423126-2-52-01, 429300-2-52-01

03-20-2024

WEEKLY PROJECT UPDATE

NEW TRAFFIC PATTERN ON WESTBOUND I-395

On **WEDNESDAY MORNING, MARCH 27 (THURSDAY MORNING, MARCH 28 IS AN ALTERNATE DATE)**, a new traffic pattern will be implemented on the ramp to westbound I-395 and westbound I-395 from North Miami Avenue to I-95. Capacity will be increased on the ramp by removing an existing merge and providing two continuous lanes onto I-395 as shown below. Drivers heading to northbound I-95 should use the right lane on the ramp to access the northbound exit ramp located on the rightmost I-395 mainline lane.

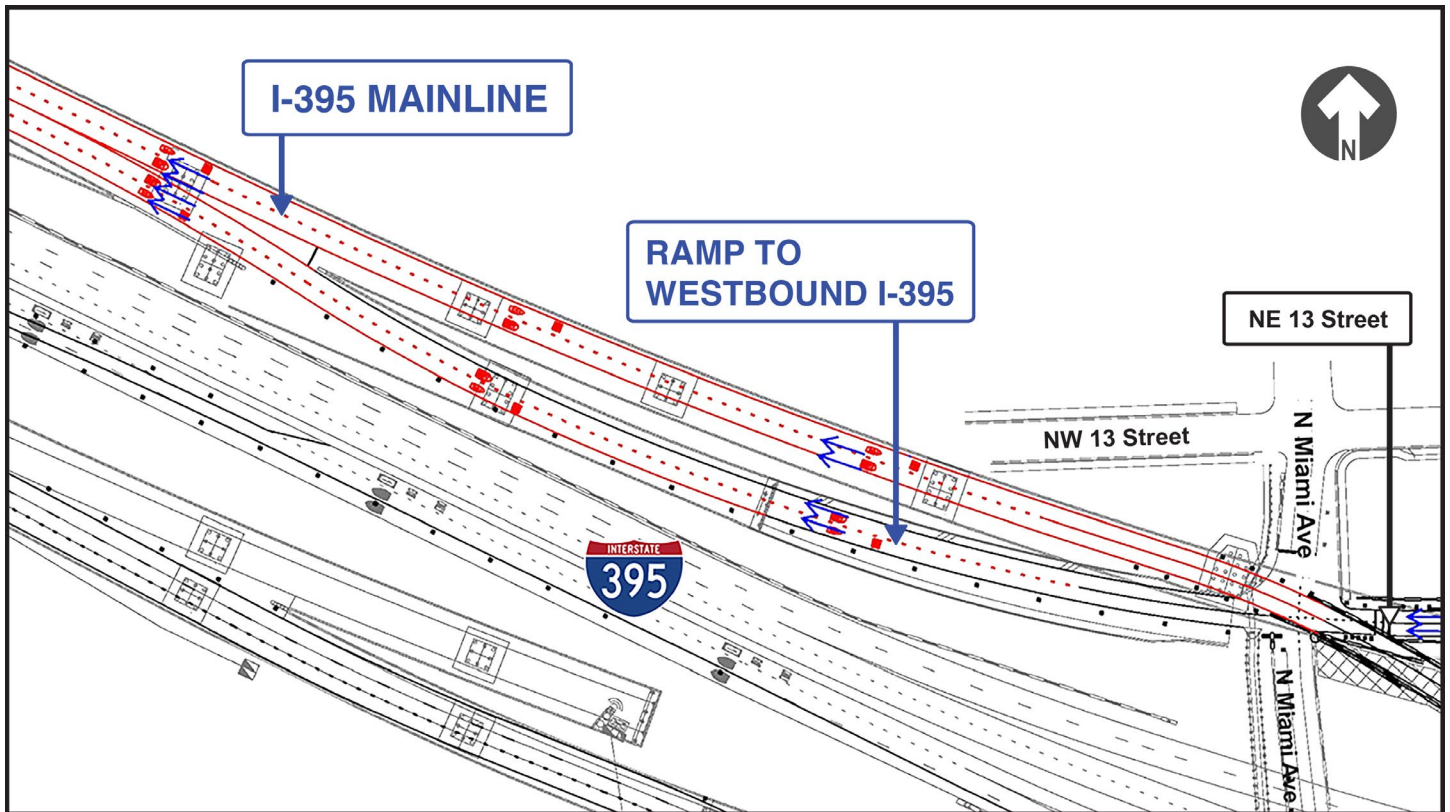

Continue reading on the next page...

In addition, capacity will also be added on I-395 from North Miami Avenue to the northbound I-95 ramp by removing a merge and adding an additional travel lane. The right lane on I-395, currently a choice lane allowing drivers to either access northbound I-95 or continue west, will be converted to an exit only lane as shown below. Drivers heading to southbound I-95 or continuing west will stay in the left three lanes that will merge to two lanes.

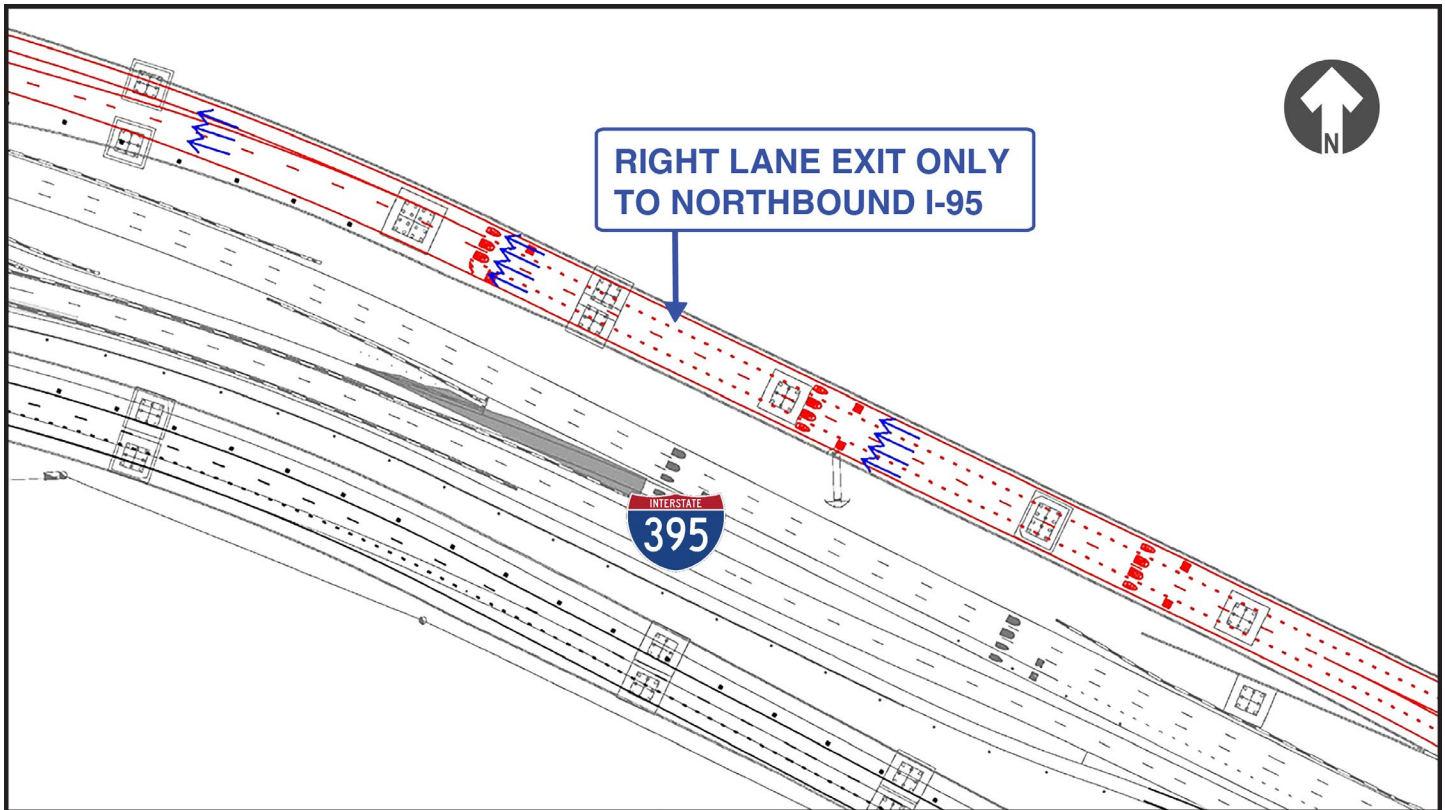

Pavement markings, signage and electronic message boards will be used to help guide drivers.

I-95 ONGOING CONSTRUCTION ACTIVITIES

- Installation of Intelligent Transportation System devices
- Concrete pavement replacement on I-95 between NW 8 Street and NW 17 Street
- Driving concrete piles into the ground for foundation construction between I-395 and NW 8 Street
- Construction of a new bridge over NW 17 Street on the SR 836/I-395 ramps to northbound I-95
- Construction of new ramp superstructure over SB I-95 for the new WB I-395 ramp to SB I-95
- Installation of new guardrail
- Traffic railing retrofit on several bridges

Continue reading on the next page...

FULL CLOSURE OF SOUTHBOUND I-95 AT SR 836

- **WEDNESDAY, MARCH 20** - All southbound lanes on I-95 will be closed at SR 836 between the hours of 10 p.m. and 5:30 a.m. for overhead work.
 - Non-Tolled detour route for southbound I-95:
 - Exit at the SR 836 West Ramp, then exit at NW 14 Street
 - Turn left at NW 12 Avenue, then turn left at NW 11 Street
 - Turn right at NW 8 Street Road, then turn left at NW 8 Street
 - Turn right at NW 3 Court to access the I-95 south ramp after NW 2 Street
 - Tolled detour route for southbound I-95:
 - Exit at the SR 836 West Ramp, then exit at NW 12 Avenue
 - Turn left at NW 12 Avenue to access the SR 836 east entrance ramp
 - Continue east on SR 836 to access the I-95 south ramp

TO VIEW A MAP OF THE DETOUR PLEASE [CLICK HERE](#).

I-95 LANE CLOSURES

- **WEDNESDAY, MARCH 20, THURSDAY, MARCH 21 AND MONDAY, MARCH 25 THROUGH FRIDAY, MARCH 29** - Up to four lanes on southbound I-95 from NW 29 Street to NW 8 Street will be closed as needed between the hours of 9 p.m. and 5:30 a.m. The closure on Fridays will be implemented between the hours of 11 p.m. and 11 a.m.
- **WEDNESDAY, MARCH 20, THURSDAY, MARCH 21 AND MONDAY, MARCH 25 THROUGH FRIDAY, MARCH 29** - Up to four lanes on northbound I-95 will be closed as needed from NW 8 Street to NW 29 Street between the hours of 9 p.m. and 5:30 a.m. The closure on Fridays will be implemented between the hours of 11 p.m. and 11 a.m.

SOUTHBOUND I-95 RAMP TO EASTBOUND I-395 DETOUR

- **WEDNESDAY, MARCH 20** - The southbound I-95 ramp to eastbound I-395 will be closed between the hours of 11:30 p.m. and 5:30 a.m. Detours are as follows:
 - Non-Tolled detour route for ramp to eastbound I-395:
 - Exit at the SR 836 West Ramp, then exit at NW 14 Street
 - Turn left at NW 12 Avenue, then turn left at NW 11 Street
 - Turn right at NW 8 Street Road, then turn left at NW 8 Street
 - Continue east on NW 8 Street, then turn left at Biscayne Boulevard to access the A1A North/ Miami Beach ramp
 - Tolled detour route for ramp to eastbound I-395:
 - Exit at the SR 836 West Ramp, then exit at NW 12 Avenue
 - Turn left at NW 12 Avenue to access the SR 836 east entrance ramp
 - Continue east on SR 836 to access eastbound I-395

TO VIEW A MAP OF THE DETOUR PLEASE [CLICK HERE](#)

Continue reading on the next page...

SOUTHBOUND I-95 RAMP TO EASTBOUND I-395 DETOUR

- **MONDAY, MARCH 25 THROUGH FRIDAY, MARCH 29** - The southbound I-95 ramp to eastbound I-395 will be closed between the hours of 10 p.m. and 5:30 a.m. Drivers can:
 - Continue south on I-95, exit at the NW 8 Street ramp (Exit 3B)
 - Turn left on NW 8 Street, continue east on NW 8 Street
 - Turn left at Biscayne Boulevard to access the A1A North/Miami Beach Ramp

TO VIEW A MAP OF THE DETOUR PLEASE [CLICK HERE](#).

NORTHBOUND I-95 RAMP TO EASTBOUND I-395 DETOUR

- **MONDAY, MARCH 25 THROUGH FRIDAY, MARCH 29** - The northbound I-95 ramp to eastbound I-395 will be closed between the hours of 10 p.m. and 5:30 a.m. Drivers can:
 - Exit at the NW 2 Street ramp (Exit 2B)
 - Continue north on NW 3 Avenue, then turn right on NW 8 Street
 - Continue east on NW/NE 8 Street
 - Turn left on Biscayne Boulevard to access A1A North/Miami Beach

TO VIEW A MAP OF THE DETOUR PLEASE [CLICK HERE](#)

NORTHBOUND I-95 RAMP TO WESTBOUND SR 836 DETOUR

- **WEDNESDAY, MARCH 20 AND THURSDAY, MARCH 28** - The northbound I-95 ramp to westbound SR 836 will be closed between the hours of 11 p.m. and 8 a.m. for overhead bridge work.
 - Drivers can:
 - Enter the eastbound I-395 ramp
 - Exit at NE 2 Avenue/Biscayne Boulevard (Exit 2B), then turn right on NE 2 Avenue
 - Turn right on NE 11 Street
 - Turn right on NE 1 Avenue to access westbound I-395 to continue onto westbound SR 836

TO VIEW A MAP OF THE DETOUR PLEASE [CLICK HERE](#).

NW 8 STREET RAMP TO NORTHBOUND I-95 CLOSURE

- **WEDNESDAY, MARCH 20, THURSDAY, MARCH 21 AND MONDAY, MARCH 25 THROUGH FRIDAY, MARCH 29** - The NW 8 Street ramp to northbound I-95 will be closed between the hours of 9 p.m. to 5:30 a.m. Closure start times may vary depending on events. Drivers can:
 - Go east on NW 8 Street
 - Turn left on NE 1 Avenue,
 - Enter the westbound I-395 ramp to access northbound I-95

TO VIEW A MAP OF THE DETOUR PLEASE [CLICK HERE](#).

Continue reading on the next page...

I-395 ONGOING CONSTRUCTION ACTIVITIES

- Construction of signature bridge arch foundations east of Biscayne Boulevard
- Construction of an elevated temporary bypass roadway at the Biscayne Boulevard ramp to the MacArthur Causeway
- Bridge construction on I-395 over Biscayne Boulevard for a future traffic shift
- Nighttime Auger Cast Pile installation for support tower foundations from east of Biscayne Boulevard to NE 1 Avenue between I-395 and NE 13 Street including in the median area of Biscayne Boulevard
- Ongoing work at four of the six signature bridge arches including placement of precast arch segments
- Preparation for the next concrete pour at the signature bridge center pier structure foundation located between Biscayne Boulevard and NE 2 Avenue just north of I-395
- Nighttime roadway operations on I-395 from MacArthur Causeway to I-95
- Nighttime erection of precast arch segments over NE 2 Avenue
- Daytime and nighttime demolition of I-395 bridges from approximately NE 1 Avenue to west of NW 3 Avenue
- Construction of support structures for construction of the signature bridge deck

FULL CLOSURE OF WESTBOUND I-395 AT THE BISCAYNE BOULEVARD EXIT RAMP

- **TUESDAY, MARCH 26 (WEDNESDAY, MARCH 27 IS AN ALTERNATE DATE)** - All westbound travel lanes on I-395 will be closed at the Biscayne Boulevard exit ramp between the hours of 11:30 p.m. and 6 a.m. to implement a traffic shift.
 - Drivers heading north on I-95 can:
 - Exit at the Biscayne Boulevard ramp, then turn left on Biscayne Boulevard
 - Turn right at NE 6 Street
 - Turn right on NW 3 Avenue to access the northbound I-95 entrance ramp at NW 8 Street
 - Drivers heading south on I-95 can:
 - Exit at the Biscayne Boulevard ramp, then turn left on Biscayne Boulevard
 - Turn right at NE 6 Street
 - Turn left at NW 3 Court to access the southbound I-95 entrance ramp at NW 2 Street
 - Drivers heading west on SR 836 can:
 - Exit at the Biscayne Boulevard ramp, then turn left on Biscayne Boulevard
 - Turn right at NE 6 Street
 - Turn left at NW 7 Avenue, go over the Miami River Bridge and turn right on NW South River Drive
 - Turn left on NW 7 Street, then turn right on NW 17 Avenue to connect with the westbound SR 836 entrance ramp

TO VIEW A MAP OF THE DETOUR PLEASE [CLICK HERE](#).

Continue reading on the next page...

FULL CLOSURE OF EASTBOUND I-395 AT I-95

- **THURSDAY, MARCH 21 AND MONDAY, MARCH 25 THROUGH FRIDAY, MARCH 29** - All eastbound travel lanes on I-395 will be closed at I-95 between the hours of 10 p.m. and 5:30 a.m. for bridge demolition activities. Drivers can:
 - Access the southbound I-95 exit, then exit at the NW 8 Street ramp
 - Continue south on NW 3 Court, then make a left at NW 5 Street
 - Turn left on Biscayne Boulevard to access the A1A North/Miami Beach ramp
- TO VIEW A MAP OF THE DETOUR PLEASE [CLICK HERE.](#)

I-395 MAINLINE LANE CLOSURES

- **WEDNESDAY, MARCH 20, THURSDAY, MARCH 21 AND MONDAY, MARCH 25 THROUGH FRIDAY, MARCH 29** - One lane on mainline eastbound I-395 will be closed as needed from I-95 to Biscayne Boulevard between the hours of 10 p.m. and 5:30 a.m.
- **WEDNESDAY, MARCH 20, THURSDAY, MARCH 21 AND MONDAY, MARCH 25 THROUGH FRIDAY, MARCH 29** - Up to two lanes on mainline westbound I-395 will be closed as needed from Biscayne Boulevard to I-95 between the hours of 10 p.m. and 5:30 a.m.

WESTBOUND I-395 RAMP TO SOUTHBOUND I-95 DETOUR

- **WEDNESDAY, MARCH 20, THURSDAY, MARCH 21 AND MONDAY, MARCH 25 THROUGH FRIDAY, MARCH 29** - The westbound I-395 ramp to southbound I-95 will be closed between the hours of 10 p.m. and 5:30 a.m. Closure start times may vary depending on events. Drivers can:
 - Go north on I-95, then exit at NW 62 Street
 - Turn left at NW 62 Street to access the southbound I-95 ramp
- TO VIEW A MAP OF THE DETOUR PLEASE [CLICK HERE.](#)

FULL CLOSURE OF BISCAYNE BOULEVARD

- **WEDNESDAY, MARCH 20, THURSDAY, MARCH 21 AND MONDAY, MARCH 25 THROUGH FRIDAY, MARCH 29** - All travel lanes on Biscayne Boulevard will be closed from NE 11 Street to NE 13 Street between the hours of 10 p.m. and 5:30 a.m. Closure start times may vary depending on events.
 - Drivers on southbound Biscayne Boulevard can:
 - Turn right on NE 13 Street, then turn left on NE 2 Avenue
 - Turn left on NE 8 Street to access Biscayne Boulevard
 - Drivers on northbound Biscayne Boulevard can:
 - Turn left on NE 11 Street, then turn right on NE 1 Avenue
 - Turn right on NE 14 Street to connect with Biscayne Boulevard
- TO VIEW A MAP OF THE DETOURS PLEASE [CLICK HERE.](#)

Continue reading on the next page...

CLOSURE OF NW 14 STREET FROM NW 7 AVENUE TO NW 1 AVENUE

- **MONDAY, MARCH 25 THROUGH FRIDAY, MARCH 29** - NW 14 Street will be closed as needed from NW 7 Avenue to NW 1 Avenue between the hours of 10 p.m. and 5:30 a.m. to allow the contractor to work on segmental bridge construction over the roadway. Drivers can use NW 17 Street as an alternate route. Closures will also be implemented as needed between the hours of 9 a.m. and 3:30 p.m.

TO VIEW A MAP OF THE DETOUR PLEASE [CLICK HERE](#).

SR 836 ONGOING CONSTRUCTION ACTIVITIES

- Installation of SR 836 bridge pier cap segments and beams for the double-decked roadway using the overhead lifter
- Driving steel sheets into the ground in the SR 836 median between NW 12 Avenue and NW 7 Avenue
- Demolition of the median on eastbound SR 836 over NW 14 Street and NW 10 Avenue
- Nighttime installation of Auger Cast Piles in the SR 836 median and adjacent roadways from NW 12 Avenue to I-95 for the new double-decked roadway
- Pier construction activities in the Miami River east bank between the shoreline and the fendering system
- Pier construction at the Richard E. Gerstein Justice Building parking area
- Ongoing casting of bridge caps
- Construction of double-decked piers at the core of the interchange

SR 836 LANE CLOSURES

- **WEDNESDAY, MARCH 20, THURSDAY, MARCH 21 AND MONDAY, MARCH 25 THROUGH FRIDAY, MARCH 29** - Two eastbound lanes on SR 836 from NW 17 Avenue to I-95 will be closed as needed for bridge work between the hours of 9 p.m. and 5:30 a.m.
- **SATURDAY, MARCH 23** - One left eastbound lane on SR 836 will be closed between the hours of 8 a.m. to 4 p.m. to drive steel sheeting in the median.
- **WEDNESDAY, MARCH 20, THURSDAY, MARCH 21 AND MONDAY, MARCH 25 THROUGH FRIDAY, MARCH 29** - Two westbound lanes on SR 836 from I-95 to NW 17 Avenue will be closed as needed for bridge work between the hours of 9 p.m. and 5:30 a.m.

Continue reading on the next page...

EASTBOUND SR 836 RAMP TO NORTHBOUND I-95 DETOUR

- **WEDNESDAY, MARCH 20 AND THURSDAY, MARCH 21** - The eastbound SR 836 ramp to northbound I-95 will be closed as needed between the hours of 9 p.m. and 5:30 a.m. Drivers can:
 - Access the southbound I-95/NW 8 Street ramp, then exit at the NW 8 Street/PortMiami ramp
 - Turn left at NW 8 Street
 - Turn left at NW 3 Avenue to access the northbound I-95 ramp

TO VIEW A MAP OF THE DETOUR PLEASE [CLICK HERE](#).

CLOSURE OF NW NORTH RIVER DRIVE/NW 11 STREET

- **WEDNESDAY, MARCH 20 AND THURSDAY, MARCH 21** - All travel lanes on NW North River Drive/ NW 11 Street will be closed between the hours of 9 p.m. and 5:30 a.m. Drivers can use the detour route shown [HERE](#). One lane will be closed between the hours of 9 a.m. and 4 p.m. as needed during the weekdays.

ABOUT THE PROJECT

The I-395/SR 836/I-95 Design-Build Project will add capacity, enhance the flow of traffic and safety and improve access along I-395, SR 836 and I-95.

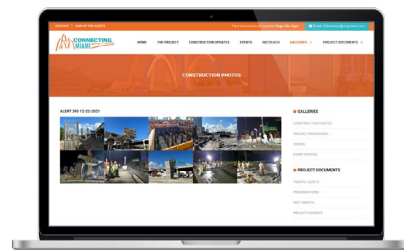

Continue reading on the next page...

Please note that this schedule may change due to bad weather or other unforeseen conditions.

The work is part of the I-395/SR 836/I-95 Design-Build Project that will reconstruct the I-395 corridor from the SR 836/I-395/I-95 (Midtown) Interchange to the MacArthur Causeway Bridge, including the construction of a Signature Bridge over NE 2 Avenue and Biscayne Boulevard; double-deck SR 836 from west of NW 17 Avenue to the Midtown Interchange and the replacement of the concrete pavement on I-95 from NW 8 Street to NW 29 Street.

For additional information on the project please contact Oscar Gonzalez at 786-280-0983 or via email at I-395 Project Oscar.Gonzalez2@dot.state.fl.us. Additional project information can be found on the project website, www.I-395miami.com.

For information on scheduled lane closures on FDOT Construction Projects that affect traffic to/from and in Miami Beach, please [click here](#).