

I-395/SR 836/I-95 DESIGN-BUILD PROJECT

Financial Project Numbers: 251688-1-52-01, 423126-1-52-01, 423126-2-52-01, 429300-2-52-01

03-04-2024

POSTPONED: NEW TRAFFIC PATTERN ON WESTBOUND I-395

Due to inclement weather, the new traffic pattern originally scheduled for today, Monday Morning, March 4, is now being scheduled, weather permitting, for **TUESDAY MORNING, MARCH 5**. The new traffic pattern will be implemented on the ramp to westbound I-395 and westbound I-395 from North Miami Avenue to I-95. Capacity will be increased on the ramp by removing an existing merge and providing two continuous lanes onto I-395 as shown below. Drivers heading to northbound I-95 should use the right lane on the ramp to access the northbound exit ramp located on the rightmost I-395 mainline lane.

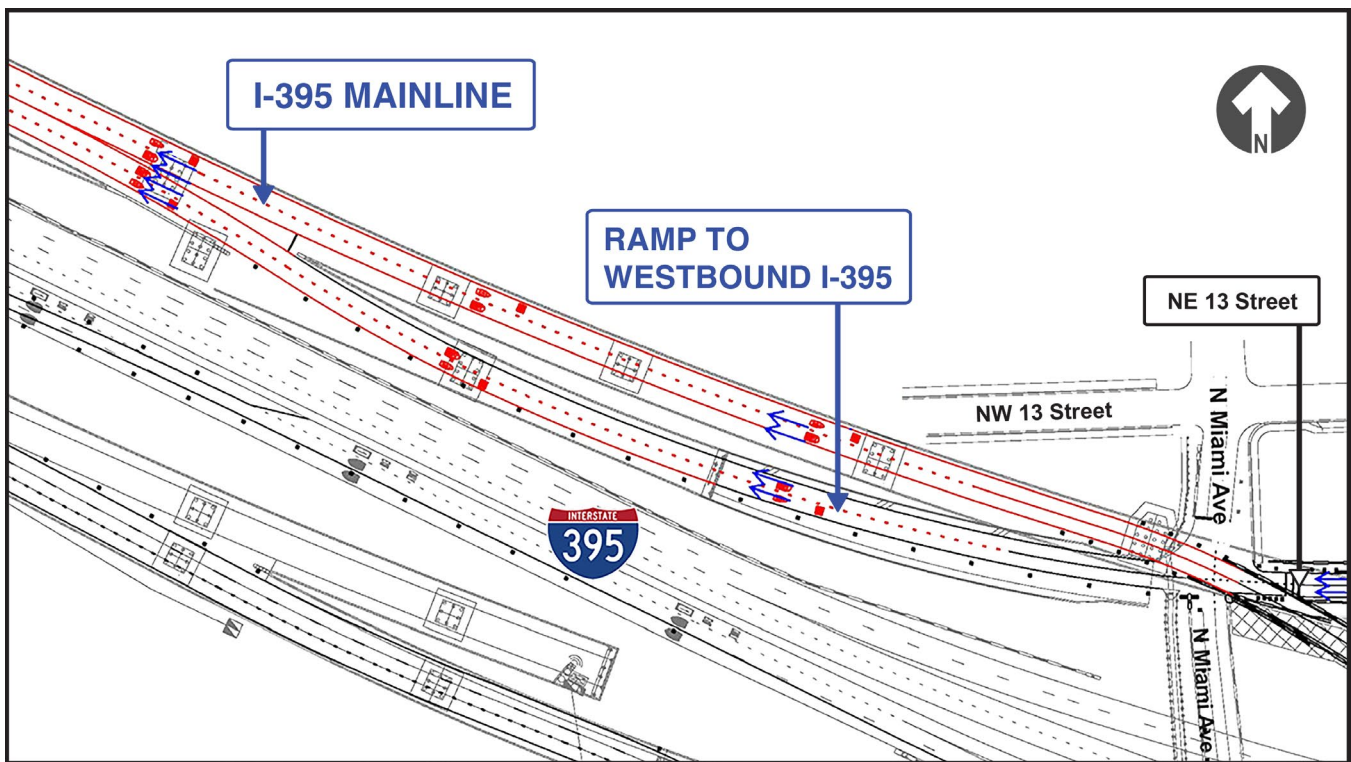

In addition, capacity will also be added on I-395 from North Miami Avenue to the northbound I-95 ramp by removing a merge and adding an additional travel lane. The right lane on I-395, currently a choice lane allowing drivers to either access northbound I-95 or continue west, will be converted to an exit only lane as shown below. Drivers heading to southbound I-95 or continuing west will stay in the left three lanes that will merge to two lanes.

Continue reading on the next page...

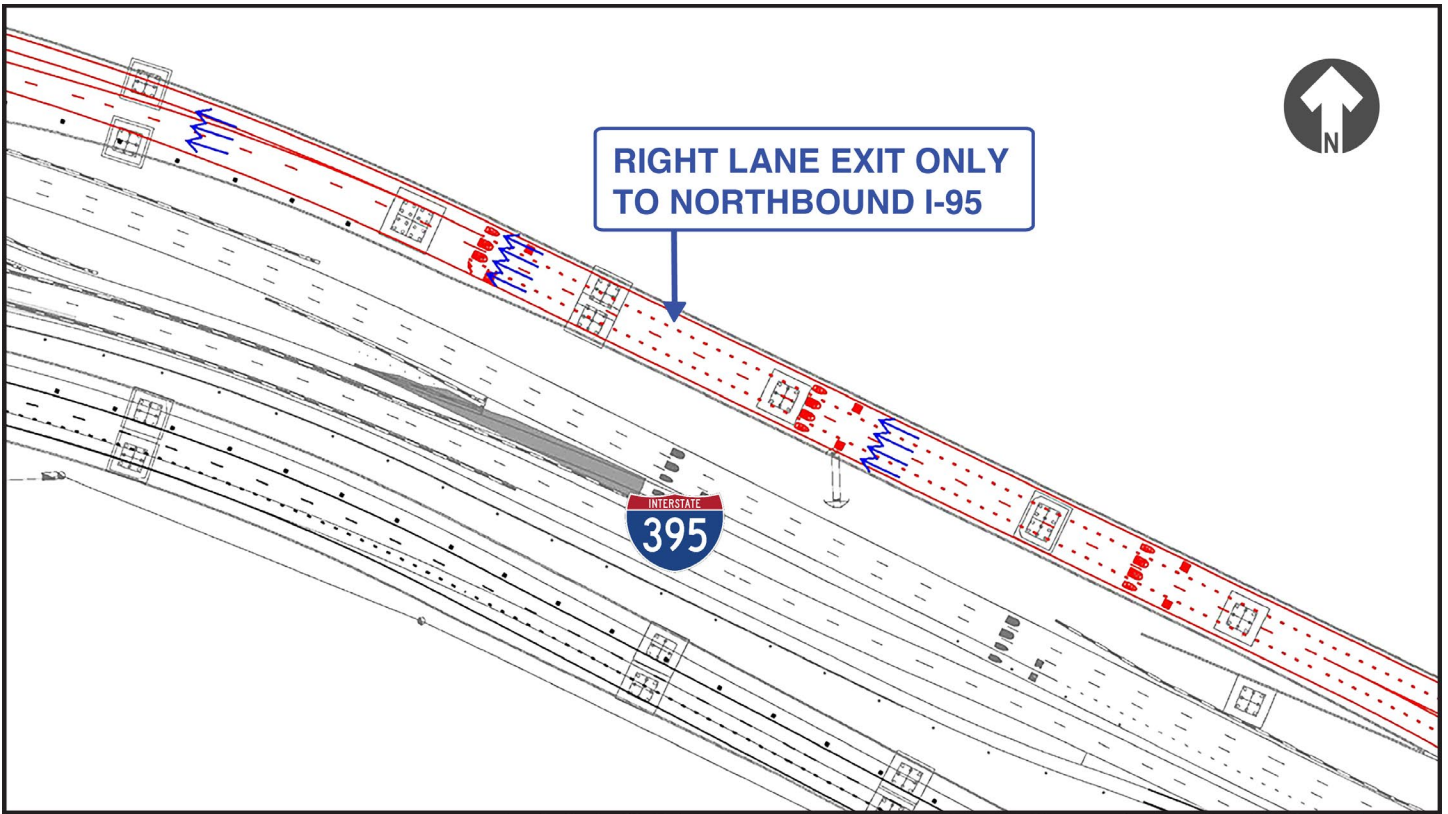

Pavement markings, signage and electronic message boards will be used to help guide drivers.

In order to implement the new traffic pattern, the following closures will be implemented:

I-395 MAINLINE LANE CLOSURE

- **MONDAY, MARCH 4** - One lane on mainline westbound I-395 will be closed from Biscayne Boulevard to I-95 between the hours of 10 p.m. and 5:30 a.m.

WESTBOUND I-395 RAMP TO NORTHBOUND I-95 DETOUR

- **MONDAY, MARCH 4** - The westbound I-395 ramp to northbound I-95 will be closed as needed between the hours of 10 p.m. and 5:30 a.m. To view a map of the detour, click [HERE](#)

CLOSURE OF NORTH MIAMI AVENUE RAMP WESTBOUND I-395 NORTHBOUND I-95 DETOUR

- **MONDAY, MARCH 4** - The North Miami Avenue ramp to westbound I-395 will be closed between the hours of 10 p.m. and 5:30 a.m. To view a map of the detour, click [HERE](#).

Continue reading on the next page...

ABOUT THE PROJECT

The I-395/SR 836/I-95 Design-Build Project will add capacity, enhance the flow of traffic and safety and improve access along I-395, SR 836 and I-95.



To view a video of the project,
please visit:

i395-miami.com/project-video

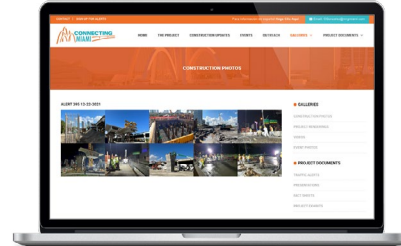

To view updated project photos,
please visit:

i395-miami.com/construction-photos

Please note that this schedule may change due to bad weather or other unforeseen conditions.

The work is part of the I-395/SR 836/I-95 Design-Build Project that will reconstruct the I-395 corridor from the SR 836/I-395/I-95 (Midtown) Interchange to the MacArthur Causeway Bridge, including the construction of a Signature Bridge over NE 2 Avenue and Biscayne Boulevard; double-deck SR 836 from west of NW 17 Avenue to the Midtown Interchange and the replacement of the concrete pavement on I-95 from NW 8 Street to NW 29 Street.

For additional information on the project please contact Oscar Gonzalez at 786-280-0983 or via email at Oscar.Gonzalez2@dot.state.fl.us. Additional project information can be found on the project website, www.I-395miami.com.

For information on scheduled lane closures on FDOT Construction Projects that affect traffic to/from and in Miami Beach, please [click here](#).