

# I-395/SR 836/I-95 DESIGN-BUILD PROJECT

Financial Project Numbers: 251688-1-52-01, 423126-1-52-01, 423126-2-52-01, 429300-2-52-01

03-03-2024

## NEW TRAFFIC PATTERN ON WESTBOUND I-395

On **MONDAY MORNING, MARCH 4**, a new traffic pattern will be implemented on the ramp to westbound I-395 and westbound I-395 from North Miami Avenue to I-95. Capacity will be increased on the ramp by removing an existing merge and providing two continuous lanes onto I-395 as shown below. Drivers heading to northbound I-95 should use the right lane on the ramp to access the northbound exit ramp located on the rightmost I-395 mainline lane.

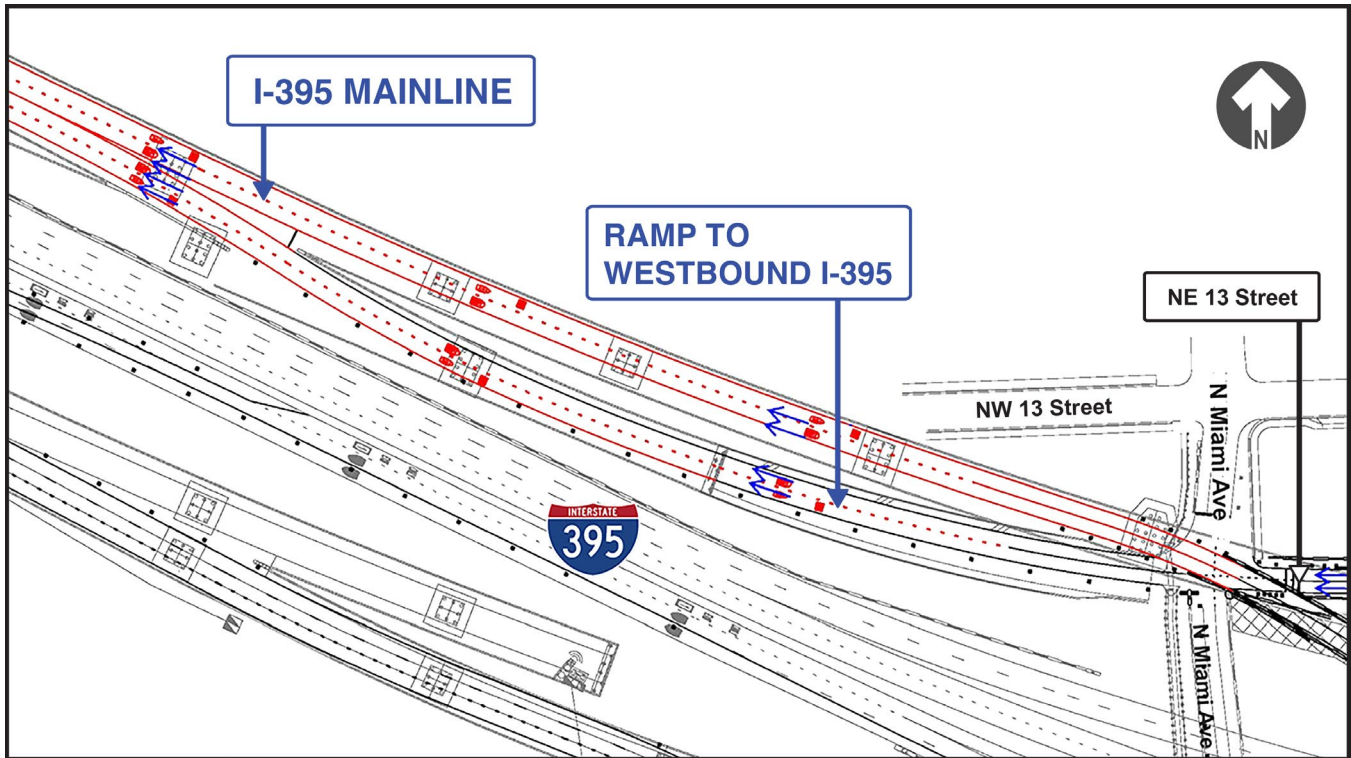

In addition, capacity will also be added on I-395 from North Miami Avenue to the northbound I-95 ramp by removing a merge and adding an additional travel lane. The right lane on I-395, currently a choice lane allowing drivers to either access northbound I-95 or continue west, will be converted to an exit only lane as shown below. Drivers heading to southbound I-95 or continuing west will stay in the left three lanes that will merge to two lanes.

*Continue reading on the next page...*

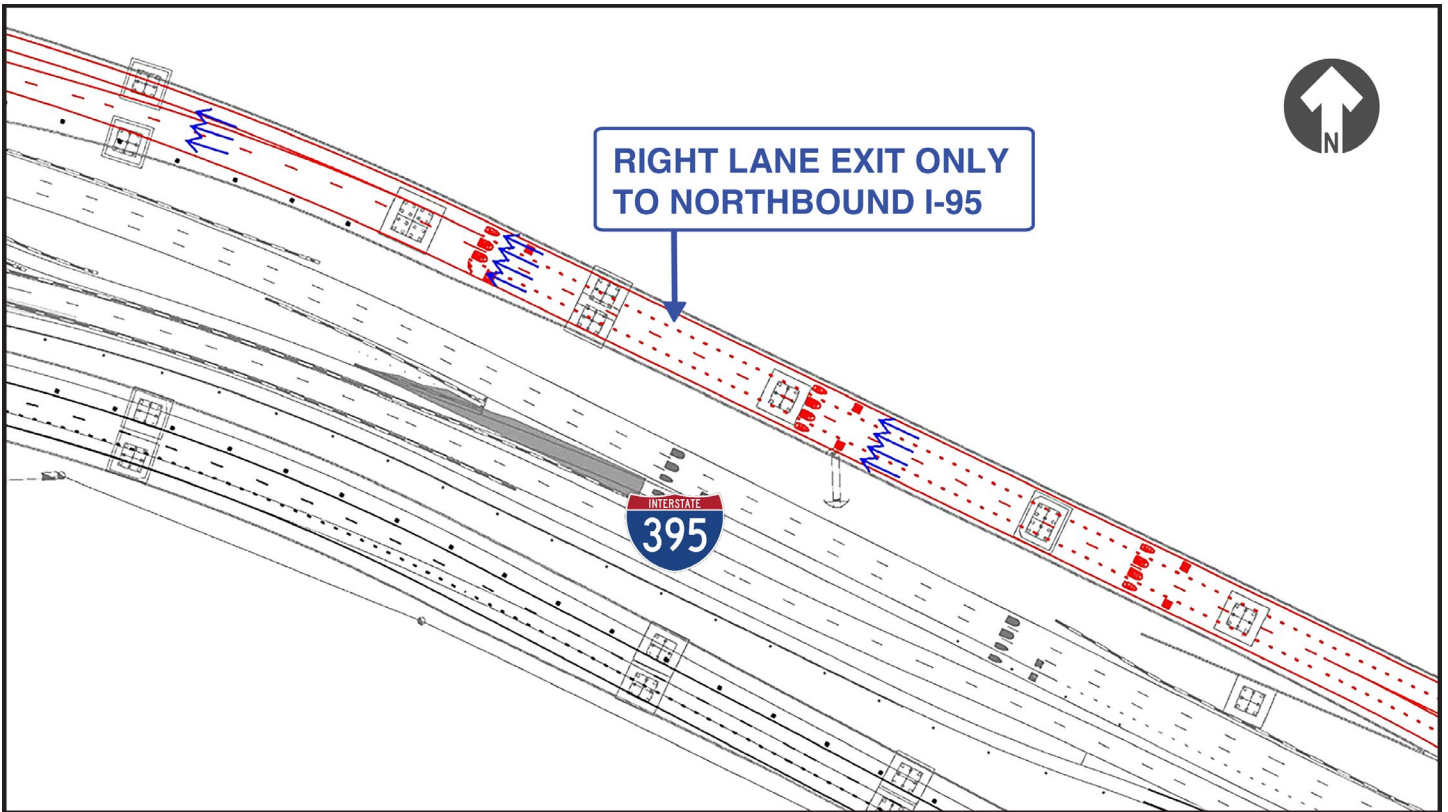

Pavement markings, signage and electronic message boards will be used to help guide drivers.

In order to implement the new traffic pattern, the following closures will be implemented:

## I-395 MAINLINE LANE CLOSURE

- **SUNDAY, MARCH 3** - One lane on mainline westbound I-395 will be closed from Biscayne Boulevard to I-95 between the hours of 10 p.m. and 5:30 a.m.

## WESTBOUND I-395 RAMP TO NORTHBOUND I-95 DETOUR

- **SUNDAY, MARCH 3** - The westbound I-395 ramp to northbound I-95 will be closed as needed between the hours of 10 p.m. and 5:30 a.m. To view a map of the detour, click [HERE](#)

## CLOSURE OF NORTH MIAMI AVENUE RAMP WESTBOUND I-395 NORTHBOUND I-95 DETOUR

- **SUNDAY, MARCH 3** - The North Miami Avenue ramp to westbound I-395 will be closed between the hours of 10 p.m. and 5:30 a.m. To view a map of the detour, click [HERE](#).

*Continue reading on the next page...*

---

## ABOUT THE PROJECT

The I-395/SR 836/I-95 Design-Build Project will add capacity, enhance the flow of traffic and safety and improve access along I-395, SR 836 and I-95.



To view a video of the project,  
please visit:

[i395-miami.com/project-video](http://i395-miami.com/project-video)

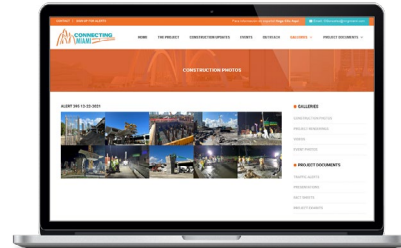

To view updated project photos,  
please visit:

[i395-miami.com/construction-photos](http://i395-miami.com/construction-photos)

---

**Please note that this schedule may change due to bad weather or other unforeseen conditions.**

The work is part of the I-395/SR 836/I-95 Design-Build Project that will reconstruct the I-395 corridor from the SR 836/I-395/I-95 (Midtown) Interchange to the MacArthur Causeway Bridge, including the construction of a Signature Bridge over NE 2 Avenue and Biscayne Boulevard; double-deck SR 836 from west of NW 17 Avenue to the Midtown Interchange and the replacement of the concrete pavement on I-95 from NW 8 Street to NW 29 Street.

For additional information on the project please contact Oscar Gonzalez at 786-280-0983 or via email at [Oscar.Gonzalez2@dot.state.fl.us](mailto:Oscar.Gonzalez2@dot.state.fl.us). Additional project information can be found on the project website, [www.I-395miami.com](http://www.I-395miami.com).

---

For information on scheduled lane closures on FDOT Construction Projects that affect traffic to/from and in Miami Beach, please [click here](#).